

FEDERAL EMERGENCY MANAGEMENT AGENCY
NATIONAL FLOOD INSURANCE PROGRAM

ELEVATION CERTIFICATE

O.M.B. No. 3067-0077
Expires July 31, 2002

Important: Read the instructions on pages 1 - 7.

01-0012.20

SECTION A - PROPERTY OWNER INFORMATION

BUILDING OWNER'S NAME: Cornerstone Builders
 BUILDING STREET ADDRESS (including Apt., Unit, Suite, and/or Bldg. No.) OR P.O. ROUTE AND BOX NO.: 10 Sundance Road
 CITY: Pooler STATE: GA ZIP CODE: 31322
 PROPERTY DESCRIPTION (Lot and Block Numbers, Tax Parcel Number, Legal Description, etc.): Lot 20 Raindance @ Pine Barren Plantation
 BUILDING USE (e.g., Residential, Non-residential, Addition, Accessory, etc. Use Comments section if necessary.): Residential
 LATITUDE/LONGITUDE (OPTIONAL) (###-##-### or ###.####): _____ HORIZONTAL DATUM: NAD 1927 NAD 1983 SOURCE: GPS (Type): _____ USGS Quad Map Other: _____

For Insurance Company Use:
 Policy Number _____
 Company NAIC Number _____

SECTION B - FLOOD INSURANCE RATE MAP (FIRM) INFORMATION

B1. NFIP COMMUNITY NAME & COMMUNITY NUMBER: Pooler 130261 B2. COUNTY NAME: Chatham B3. STATE: GA
 B4. MAP AND PANEL NUMBER: 130030 - 75 B5. SUFFIX: C B6. FIRM INDEX DATE: 9/20/95 B7. FIRM PANEL EFFECTIVE/REVISED DATE: 8/19/87 B8. FLOOD ZONE(S): AE B9. BASE FLOOD ELEVATION(S) (Zone AO, use depth of flooding): 12.0

B10. Indicate the source of the Base Flood Elevation (BFE) data or base flood depth entered in B9:
 FIS Profile FIRM Community Determined Other (Describe): _____
 B11. Indicate the elevation datum used for the BFE in B9: NGVD 1929 NAVD 1988 Other (Describe): _____
 B12. Is the building located in a Coastal Barrier Resources System (CBRS) area or Otherwise Protected Area (OPA)? Yes No
 Designation Date: _____

SECTION C - BUILDING ELEVATION INFORMATION (SURVEY REQUIRED)

C1. Building elevations are based on: Construction Drawings Building Under Construction Finished Construction
 *A new Elevation Certificate will be required when construction of the building is complete.
 C2. Building Diagram Number 1 (Select the building diagram most similar to the building for which this certificate is being completed - see pages 6 and 7. If no diagram accurately represents the building, provide a sketch or photograph.)
 C3. Elevations - Zones A1-A30, AE, AH, A (with BFE), VE, V1-V30, V (with BFE), AR, AR/A, AR/AE, AR/A1-A30, AR/AH, AR/AO
 Complete items C3a-f below according to the building diagram specified in item C2. State the datum used. If the datum is different from the datum used for the BFE in Section B, convert the datum to that used for the BFE. Show field measurements and datum conversion calculation. Use the space provided or the Comments area of Section D or Section G, as appropriate, to document the datum conversion.
 Datum NGVD/29 Conversion/Comments: _____
 Elevation reference mark used TBM Does the elevation reference mark used appear on the FIRM? Yes No
 a) Top of bottom floor (including basement or enclosure) 19.95 ft.(m) Slab on grade
 b) Top of next higher floor N/A ft.(m)
 c) Bottom of lowest horizontal structural member (V zones only) N/A ft.(m)
 d) Attached garage (top of slab) 19.84 ft.(m)
 e) Lowest elevation of machinery and/or equipment servicing the building N/A ft.(m)
 f) Lowest adjacent grade (LAG) 19.04 ft.(m)
 g) Highest adjacent grade (HAG) 19.44 ft.(m)
 h) No. of permanent openings (flood vents) within 1 ft. above adjacent grade N/A
 i) Total area of all permanent openings (flood vents) in C3h N/A sq. in. (sq. cm)

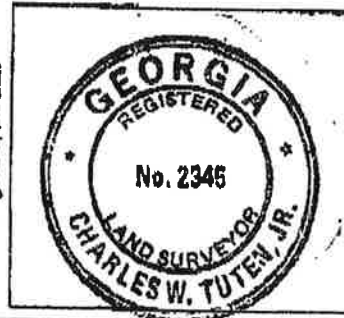

SECTION D - SURVEYOR, ENGINEER, OR ARCHITECT CERTIFICATION

This certification is to be signed and sealed by a land surveyor, engineer, or architect authorized by law to certify elevation information. I certify that the information in Sections A, B, and C on this certificate represents my best efforts to interpret the data available. I understand that any false statement may be punishable by fine or imprisonment under 18 U.S. Code, Section 1001.
 CERTIFIER'S NAME: Charles W. Tuten, Jr. LICENSE NUMBER: GA RLS # 2345

TITLE: Registered Land Surveyor COMPANY NAME: EMC Engineering Services, Inc.
 ADDRESS: 23 East Chatham Street CITY: Savannah STATE: GA ZIP CODE: 31401
 SIGNATURE: Charles W. Tuten, Jr. DATE: January 8, 2001 TELEPHONE: 912-232-8633