

FEDERAL EMERGENCY MANAGEMENT AGENCY  
NATIONAL FLOOD INSURANCE PROGRAM

00-0302, 20

O.M.B. No. 3067-0077  
Expires July 31, 2002

**ELEVATION CERTIFICATE**

Important: Read the instructions on pages 1 - 7.

<b>SECTION A - PROPERTY OWNER INFORMATION</b>			For Insurance Company Use:
BUILDING OWNER'S NAME East Coast Homes		Policy Number	
BUILDING STREET ADDRESS (Including Apt., Unit, Suite, and/or Bldg. No.) OR P.O. ROUTE AND BOX NO. 1315 Ryan's Way		Company NAIC Number	
CITY Pooler	STATE GA	ZIP CODE 31322	
PROPERTY DESCRIPTION (Lot and Block Numbers, Tax Parcel Number, Legal Description, etc.) Lot 346, Garden Acres Estates, Phase 12 & 13			
BUILDING USE (e.g., Residential, Non-residential, Addition, Accessory, etc. Use Comments section if necessary.) Residential			
LATITUDE/LONGITUDE (OPTIONAL) ( ##° - ##' - ###.###" or ##.##### )		HORIZONTAL DATUM: SOURCE: <input type="checkbox"/> GPS (Type): _____ <input type="checkbox"/> NAD 1927 <input type="checkbox"/> NAD 1983 <input type="checkbox"/> USGS Quad Map <input type="checkbox"/> Other: _____	

**SECTION B - FLOOD INSURANCE RATE MAP (FIRM) INFORMATION**

B1. NFIP COMMUNITY NAME & COMMUNITY NUMBER Pooler 130216		B2. COUNTY NAME Chatham		B3. STATE Georgia	
B4. MAP AND PANEL NUMBER 130030-75	B5. SUFFIX C	B6. FIRM INDEX DATE 09-20-95	B7. FIRM PANEL EFFECTIVE/REVISED DATE 05-19-87	B8. FLOOD ZONE(S) AE	B9. BASE FLOOD ELEVATION(S) (Zone AO, use depth of flooding) 14.0

B10. Indicate the source of the Base Flood Elevation (BFE) data or base flood depth entered in B9.  
 FIS Profile  FIRM  Community Determined  Other (Describe): \_\_\_\_\_

B11. Indicate the elevation datum used for the BFE in B9:  NGVD 1929  NAVD 1988  Other (Describe): \_\_\_\_\_

B12. Is the building located in a Coastal Barrier Resources System (CBRS) area or Otherwise Protected Area (OPA)?  Yes  No  
 Designation Date \_\_\_\_\_ SEE NOTE ON BACK

**SECTION C - BUILDING ELEVATION INFORMATION (SURVEY REQUIRED)**

Building elevations are based on:  Construction Drawings\*  Building Under Construction\*  Finished Construction  
 \*A new Elevation Certificate will be required when construction of the building is complete.

Building Diagram Number 1 (Select the building diagram most similar to the building for which this certificate is being completed - see pages 6 and 7. If no diagram accurately represents the building, provide a sketch or photograph.)

C3. Elevations - Zones A1-A30, AE, AH, A (with BFE), VE, V1-V30, V (with BFE), AR, AR/A, AR/AE, AR/A1-A30, AR/AH, AR/AO  
 Complete Items C3a-i below according to the building diagram specified in Item C2. State the datum used. If the datum is different from the datum used for the BFE in Section B, convert the datum to that used for the BFE. Show field measurements and datum conversion calculation. Use the space provided or the Comments area of Section D or Section G, as appropriate, to document the datum conversion.  
 Datum NGVD/29 Conversion/Comments \_\_\_\_\_

Elevation reference mark used TBM Does the elevation reference mark used appear on the FIRM?  Yes  No

a) Top of bottom floor (including basement or enclosure) 16.56 ft.(m)  
 b) Top of next higher floor n/a . \_\_\_\_ ft.(m)  
 c) Bottom of lowest horizontal structural member (V zones only) n/a . \_\_\_\_ ft.(m)  
 d) Attached garage (top of slab) 16.16 ft.(m)  
 e) Lowest elevation of machinery and/or equipment servicing the building 16.47 ft.(m)  
 f) Lowest adjacent grade (LAG) 16.03 ft.(m)  
 g) Highest adjacent grade (HAG) 16.29 ft.(m)  
 h) No. of permanent openings (flood vents) within 1 ft. above adjacent grade n/a  
 i) Total area of all permanent openings (flood vents) in C3h n/a sq. in. (sq. cm)

License Number, Embossed Seal, Signature, and Date

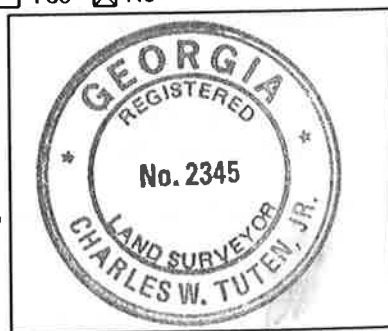

**SECTION D - SURVEYOR, ENGINEER, OR ARCHITECT CERTIFICATION**

This certification is to be signed and sealed by a land surveyor, engineer, or architect authorized by law to certify elevation information.  
 I certify that the information in Sections A, B, and C on this certificate represents my best efforts to interpret the data available.  
 I understand that any false statement may be punishable by fine or imprisonment under 18 U.S. Code, Section 1001.

CERTIFIER'S NAME Charles W. Tuten, Jr. LICENSE NUMBER GA RLS 2345

TITLE Land Surveyor COMPANY NAME EMC Engineering Services, Inc.

ADDRESS 4 East Charlton Street CITY Savannah STATE GA ZIP CODE 31401  
 SIGNATURE Charles W. Tuten, Jr. DATE 05/23/00 TELEPHONE 912-232-6533

<b>IMPORTANT: In these spaces, copy the corresponding information from Section A.</b>			For Insurance Company Use:
BUILDING STREET ADDRESS (Including Apt., Unit, Suite, and/or Bldg. No.) OR P.O. ROUTE AND BOX NO.			Policy Number
CITY	STATE	ZIP CODE	Company NAIC Number

**SECTION D - SURVEYOR, ENGINEER, OR ARCHITECT CERTIFICATION (CONTINUED)**

Copy both sides of this Elevation Certificate for (1) community official, (2) insurance agent/company, and (3) building owner.

COMMENTS Based upon the FEMA Case #00-04-1404 A this lot has been removed from the Special Flood Hazard Line.

Check here if attachments

**SECTION E - BUILDING ELEVATION INFORMATION (SURVEY NOT REQUIRED) FOR ZONE AO AND ZONE A (WITHOUT BFE)**

For Zone AO and Zone A (without BFE), complete Items E1 through E4. *If the Elevation Certificate is intended for use as supporting information for a LOMA or LOMR-F, Section C must be completed.*

- E1. Building Diagram Number \_\_ (Select the building diagram most similar to the building for which this certificate is being completed – see pages 6 and 7. If no diagram accurately represents the building, provide a sketch or photograph.)
- E2. The top of the bottom floor (including basement or enclosure) of the building is \_\_ ft.(m) \_\_ in.(cm)  above or  below (check one) the highest adjacent grade.
- E3. For Building Diagrams 6-8 with openings (see page 7), the next higher floor or elevated floor (elevation b) of the building is \_\_ ft.(m) \_\_ in.(cm) above the highest adjacent grade.
- E4. For Zone AO only: If no flood depth number is available, is the top of the bottom floor elevated in accordance with the community's floodplain management ordinance?  Yes  No  Unknown. The local official must certify this information in Section G.

**SECTION F - PROPERTY OWNER (OR OWNER'S REPRESENTATIVE) CERTIFICATION**

The property owner or owner's authorized representative who completes Sections A, B, and E for Zone A (without a FEMA-issued or community-issued BFE) or Zone AO must sign here.

PROPERTY OWNER'S OR OWNER'S AUTHORIZED REPRESENTATIVE'S NAME			
ADDRESS	CITY	STATE	ZIP CODE
SIGNATURE	DATE	TELEPHONE	
COMMENTS			

Check here if attachments

**SECTION G - COMMUNITY INFORMATION (OPTIONAL)**

The local official who is authorized by law or ordinance to administer the community's floodplain management ordinance can complete Sections A, B, C (or E), and G of this Elevation Certificate. Complete the applicable item(s) and sign below.

- G1.  The information in Section C was taken from other documentation that has been signed and embossed by a licensed surveyor, engineer, or architect who is authorized by state or local law to certify elevation information. (Indicate the source and date of the elevation data in the Comments area below.)
- G2.  A community official completed Section E for a building located in Zone A (without a FEMA-issued or community-issued BFE) or Zone AO.
- G3.  The following information (Items G4-G9) is provided for community floodplain management purposes.

G4. PERMIT NUMBER	G5. DATE PERMIT ISSUED	G6. DATE CERTIFICATE OF COMPLIANCE/OCCUPANCY ISSUED
-------------------	------------------------	---

G7. This permit has been issued for:  New Construction  Substantial Improvement

G8. Elevation of as-built lowest floor (including basement) of the building is: \_\_\_\_\_ ft.(m) Datum: \_\_\_\_\_

G9. BFE or (in Zone AO) depth of flooding at the building site is: \_\_\_\_\_ ft.(m) Datum: \_\_\_\_\_

LOCAL OFFICIAL'S NAME	TITLE
COMMUNITY NAME	TELEPHONE
SIGNATURE	DATE
COMMENTS	

Check here if attachments

FEDERAL EMERGENCY MANAGEMENT AGENCY  
NATIONAL FLOOD INSURANCE PROGRAM

O.M.B. No. 3067-0077  
Expires July 31, 2002

ELEVATION CERTIFICATE

Important: Read the instructions on pages 1 - 7.

**SECTION A - PROPERTY OWNER INFORMATION**

PROPERTY OWNER'S NAME: East Coast Homes

BUILDING STREET ADDRESS (Including Apt., Unit, Suite, and/or Bldg. No.) OR P.O. ROUTE AND BOX NO.: 1315 Lyons Way

CITY: Pooler STATE: GA ZIP CODE: 31322

PROPERTY DESCRIPTION (Lot and Block Numbers, Tax Parcel Number, Legal Description, etc.): Lot 346 Phase XIII Garden Acres

BUILDING USE (e.g., Residential, Non-residential, Addition, Accessory, etc. Use Comments section if necessary.): Residential

LATITUDE/LONGITUDE (OPTIONAL) (##° - ##' - ##.###" or ##.#####°): \_\_\_\_\_ HORIZONTAL DATUM:  NAD 1927  NAD 1983 SOURCE:  GPS (Type): \_\_\_\_\_  USGS Quad Map  Other: \_\_\_\_\_

**SECTION B - FLOOD INSURANCE RATE MAP (FIRM) INFORMATION**

B1. NFIP COMMUNITY NAME & COMMUNITY NUMBER: Pooler 130216 B2. COUNTY NAME: Chatham B3. STATE: GA

B4. MAP AND PANEL NUMBER: <u>130030-75</u>	B5. SUFFIX: <u>L</u>	B6. FIRM INDEX DATE: <u>9-20-95</u>	B7. FIRM PANEL EFFECTIVE/REVISED DATE: <u>May 19, 1987</u>	B8. FLOOD ZONE(S): <u>AE</u>	B9. BASE FLOOD ELEVATION(S) (Zone AO, use depth of flooding): <u>14.0</u>
--	----------------------	-------------------------------------	--	------------------------------	---

B10. Indicate the source of the Base Flood Elevation (BFE) data or base flood depth entered in B9:  
 FIS Profile  FIRM  Community Determined  Other (Describe): \_\_\_\_\_

B11. Indicate the elevation datum used for the BFE in B9:  NGVD 1929  NAVD 1988  Other (Describe): \_\_\_\_\_

B12. Is the building located in a Coastal Barrier Resources System (CBRS) area or Otherwise Protected Area (OPA)?  Yes  No  
Designation Date: \_\_\_\_\_

**SECTION C - BUILDING ELEVATION INFORMATION (SURVEY REQUIRED)**

C1. Building elevations are based on:  Construction Drawings\*  Building Under Construction\*  Finished Construction  
\*A new Elevation Certificate will be required when construction of the building is complete.

C2. Building Diagram Number 1 (Select the building diagram most similar to the building for which this certificate is being completed - see pages 6 and 7. If no diagram accurately represents the building, provide a sketch or photograph.)

C3. Elevations - Zones A1-A30, AE, AH, A (with BFE), VE, V1-V30, V (with BFE), AR, AR/A, AR/AE, AR/A1-A30, AR/AH, AR/AO  
Complete Items C3a-i below according to the building diagram specified in Item C2. State the datum used. If the datum is different from the datum used for the BFE in Section B, convert the datum to that used for the BFE. Show field measurements and datum conversion calculation. Use the space provided or the Comments area of Section D or Section G, as appropriate, to document the datum conversion.

Datum NAVD/21 Conversion/Comments \_\_\_\_\_

Elevation reference mark used TBM Does the elevation reference mark used appear on the FIRM?  Yes  No

<input type="checkbox"/> a) Top of bottom floor (including basement or enclosure)	<u>16.55</u> ft.(m)
<input type="checkbox"/> b) Top of next higher floor	<u>N/A</u> ft.(m)
<input type="checkbox"/> c) Bottom of lowest horizontal structural member (V zones only)	<u>N/A</u> ft.(m)
<input type="checkbox"/> d) Attached garage (top of slab)	<u>16.16</u> ft.(m)
<input type="checkbox"/> e) Lowest elevation of machinery and/or equipment servicing the building	<u>16.48</u> ft.(m)
<input type="checkbox"/> f) Lowest adjacent grade (LAG)	<u>16.06</u> ft.(m)
<input type="checkbox"/> g) Highest adjacent grade (HAG)	<u>16.29</u> ft.(m)
<input type="checkbox"/> h) No. of permanent openings (flood vents) within 1 ft. above adjacent grade	<u>N/A</u>
<input type="checkbox"/> i) Total area of all permanent openings (flood vents) in C3h	<u>N/A</u> sq. in. (sq. cm)

License Number, Embossed Seal, Signature, and Date

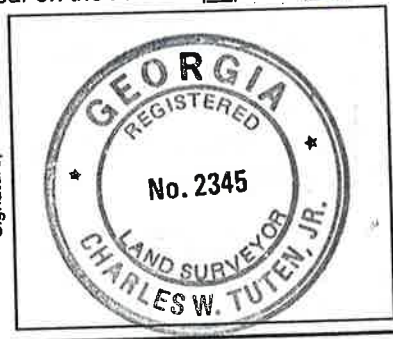

**SECTION D - SURVEYOR, ENGINEER, OR ARCHITECT CERTIFICATION**

This certification is to be signed and sealed by a land surveyor, engineer, or architect authorized by law to certify elevation information. I certify that the information in Sections A, B, and C on this certificate represents my best efforts to interpret the data available. I understand that any false statement may be punishable by fine or imprisonment under 18 U.S. Code, Section 1001.

CERTIFIER'S NAME: Charles W. Tutten LICENSE NUMBER: GA LS# 2345

TITLE: Registered Land Surveyor COMPANY NAME: EMC Engineering Services, Inc

ADDRESS: 0 23 E. Chatham St. CITY: Savannah STATE: GA ZIP CODE: 31412

SIGNATURE: Charles W. Tutten, Jr. DATE: 4-24-00 TELEPHONE: 912-232-6533

**IMPORTANT: In these spaces, copy the corresponding information from Section A.**

BUILDING STREET ADDRESS (Including Apt., Unit, Suite, and/or Bldg. No.) OR P.O. ROUTE AND BOX NO.	For Insurance Company Use: Policy Number
CITY STATE ZIP CODE	Company NAIC Number

**SECTION D - SURVEYOR, ENGINEER, OR ARCHITECT CERTIFICATION (CONTINUED)**

Copy both sides of this Elevation Certificate for (1) community official, (2) insurance agent/company, and (3) building owner.

COMMENTS

---



---

Check here if attachments

**SECTION E - BUILDING ELEVATION INFORMATION (SURVEY NOT REQUIRED) FOR ZONE AO AND ZONE A (WITHOUT BFE)**

For Zone AO and Zone A (without BFE), complete Items E1 through E4. If the Elevation Certificate is intended for use as supporting information for a LOMA or LOMR-F, Section C must be completed.

E1. Building Diagram Number \_\_\_\_ (Select the building diagram most similar to the building for which this certificate is being completed – see pages 6 and 7. If no diagram accurately represents the building, provide a sketch or photograph.)

E2. The top of the bottom floor (including basement or enclosure) of the building is \_\_\_\_ ft.(m) \_\_\_\_ in.(cm)  above or  below (check one) the highest adjacent grade.

E3. For Building Diagrams 6-8 with openings (see page 7), the next higher floor or elevated floor (elevation b) of the building is \_\_\_\_ ft.(m) \_\_\_\_ in.(cm) above the highest adjacent grade.

E4. For Zone AO only: If no flood depth number is available, is the top of the bottom floor elevated in accordance with the community's floodplain management ordinance?  Yes  No  Unknown. The local official must certify this information in Section G.

**SECTION F - PROPERTY OWNER (OR OWNER'S REPRESENTATIVE) CERTIFICATION**

The property owner or owner's authorized representative who completes Sections A, B, and E for Zone A (without a FEMA-issued or community-issued BFE) or Zone AO must sign here.

PROPERTY OWNER'S OR OWNER'S AUTHORIZED REPRESENTATIVE'S NAME \_\_\_\_\_

ADDRESS \_\_\_\_\_ CITY \_\_\_\_\_ STATE \_\_\_\_\_ ZIP CODE \_\_\_\_\_

SIGNATURE \_\_\_\_\_ DATE \_\_\_\_\_ TELEPHONE \_\_\_\_\_

COMMENTS \_\_\_\_\_

Check here if attachments

**SECTION G - COMMUNITY INFORMATION (OPTIONAL)**

The local official who is authorized by law or ordinance to administer the community's floodplain management ordinance can complete Sections A, B, C (or E), and G of this Elevation Certificate. Complete the applicable item(s) and sign below.

G1.  The information in Section C was taken from other documentation that has been signed and embossed by a licensed surveyor, engineer, or architect who is authorized by state or local law to certify elevation information. (Indicate the source and date of the elevation data in the Comments area below.)

G2.  A community official completed Section E for a building located in Zone A (without a FEMA-issued or community-issued BFE) or Zone AO.

G3.  The following information (Items G4-G9) is provided for community floodplain management purposes.

G4. PERMIT NUMBER _____	G5. DATE PERMIT ISSUED _____	G6. DATE CERTIFICATE OF COMPLIANCE/OCCUPANCY ISSUED _____
-------------------------	------------------------------	---

G7. This permit has been issued for:  New Construction  Substantial Improvement

G8. Elevation of as-built lowest floor (including basement) of the building is: \_\_\_\_\_ ft.(m) Datum: \_\_\_\_\_

G9. BFE or (in Zone AO) depth of flooding at the building site is: \_\_\_\_\_ ft.(m) Datum: \_\_\_\_\_

LOCAL OFFICIAL'S NAME \_\_\_\_\_ TITLE \_\_\_\_\_

COMMUNITY NAME \_\_\_\_\_ TELEPHONE \_\_\_\_\_

SIGNATURE \_\_\_\_\_ DATE \_\_\_\_\_

COMMENTS \_\_\_\_\_

Check here if attachments

FEDERAL EMERGENCY MANAGEMENT AGENCY  
NATIONAL FLOOD INSURANCE PROGRAM

O.M.B. No. 3067-0077  
Expires July 31, 2002

ELEVATION CERTIFICATE

Important: Read the instructions on pages 1 - 7.

**SECTION A - PROPERTY OWNER INFORMATION**

BUILDING OWNER'S NAME: East Coast Homes

BUILDING STREET ADDRESS (including Apt., Unit, Suite, and/or Bldg. No.) OR P.O. ROUTE AND BOX NO.: 1315 Fern's Way

CITY: Pooler STATE: GA ZIP CODE: 31322

PROPERTY DESCRIPTION (Lot and Block Numbers, Tax Parcel Number, Legal Description, etc.): Lot 346 Phase XII Gordon Acres Estates

BUILDING USE (e.g., Residential, Non-residential, Addition, Accessory, etc. Use Comments section if necessary.): Residential

LATITUDE/LONGITUDE (OPTIONAL) (###-##'-###.### or ###.####): \_\_\_\_\_

HORIZONTAL DATUM:  NAD 1927  NAD 1983

SOURCE:  GPS (Type): \_\_\_\_\_  USGS Quad Map  Other: \_\_\_\_\_

For Insurance Company Use:

Policy Number: \_\_\_\_\_

Company NAIC Number: \_\_\_\_\_

**SECTION B - FLOOD INSURANCE RATE MAP (FIRM) INFORMATION**

B1. NFIP COMMUNITY NAME & COMMUNITY NUMBER: Chatham 130030

B2. COUNTY NAME: Chatham

B3. STATE: GA

B4. MAP AND PANEL NUMBER: 130030-75

B5. SUFFIX: C

B6. FIRM INDEX DATE: 9-20-95

B7. FIRM PANEL EFFECTIVE/REVISED DATE: May 19, 1987

B8. FLOOD ZONE(S): A1

B9. BASE FLOOD ELEVATION (ft) (Zone A0, use depth of flooding): 14.0

B10. Indicate the source of the Base Flood Elevation (BFE) data or base flood depth entered in B9:  
 FIS Profile  FIRM  Community Determined  Other (Describe): \_\_\_\_\_

B11. Indicate the elevation datum used for the BFE in B9:  NGVD 1929  NAVD 1988  Other (Describe): \_\_\_\_\_

B12. Is the building located in a Coastal Barrier Resources System (CBRS) area or Otherwise Protected Area (OPA)?  Yes  No

Designation Date: \_\_\_\_\_

**SECTION C - BUILDING ELEVATION INFORMATION (SURVEY REQUIRED)**

C1. Building elevations are based on:  Construction Drawings\*  Building Under Construction\*  Finished Construction

\*A new Elevation Certificate will be required when construction of the building is complete.

C2. Building Diagram Number 1 (Select the building diagram most similar to the building for which this certificate is being completed - see pages 6 and 7. If no diagram accurately represents the building, provide a sketch or photograph.)

C3. Elevations - Zones A1-A30, AE, AH, A (with BFE), VE, V1-V30, V (with BFE), AR, AR/A, AR/AE, AR/A1-A30, AR/AH, AR/AO

Complete items C3a-l below according to the building diagram specified in Item C2. State the datum used. If the datum is different from the datum used for the BFE in Section B, convert the datum to that used for the BFE. Show field measurements and datum conversion calculation. Use the space provided or the Comments area of Section D or Section G, as appropriate, to document the datum conversion.

Datum: NAVD 1929 Conversion/Comments: \_\_\_\_\_

Elevation reference mark used: TRM Does the elevation reference mark used appear on the FIRM?  Yes  No

a) Top of bottom floor (including basement or enclosure) \_\_\_\_\_ ft. (m)

b) Top of next higher floor \_\_\_\_\_ ft. (m)

c) Bottom of lowest horizontal structural member (V zones only) \_\_\_\_\_ ft. (m)

d) Attached garage (top of slab) \_\_\_\_\_ ft. (m)

e) Lowest elevation of machinery and/or equipment servicing the building \_\_\_\_\_ ft. (m)

f) Lowest adjacent grade (LAG) \_\_\_\_\_ ft. (m)

g) Highest adjacent grade (HAG) \_\_\_\_\_ ft. (m)

h) No. of permanent openings (flood vents) within 1 ft. above adjacent grade \_\_\_\_\_

i) Total area of all permanent openings (flood vents) in C3h \_\_\_\_\_ sq. in. (sq. cm)

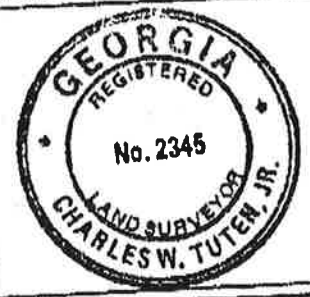

**SECTION D - SURVEYOR, ENGINEER, OR ARCHITECT CERTIFICATION**

This certification is to be signed and sealed by a land surveyor, engineer, or architect authorized by law to certify elevation information. I certify that the information in Sections A, B, and C on this certificate represents my best efforts to interpret the data available. I understand that any false statement may be punishable by fine or imprisonment under 18 U.S. Code, Section 1001.

CERTIFIER'S NAME: Charles W. Tuttle, Jr. LICENSE NUMBER: GA PLS # 2345

TITLE: Registered Land Surveyor COMPANY NAME: EMP Engineering Services I

ADDRESS: 023 E. Charlton St. CITY: Savannah STATE: GA ZIP CODE: 31412

SIGNATURE: Charles W. Tuttle, Jr. DATE: 4-20-00 TELEPHONE: 912-232-6522

