

FEDERAL EMERGENCY MANAGEMENT AGENCY
NATIONAL FLOOD INSURANCE PROGRAM

O.M.B. No. 3067-0077
Expires July 31, 2002

ELEVATION CERTIFICATE

Important: Read the instructions on pages 1 - 7.

SECTION A - PROPERTY OWNER INFORMATION

BUILDING OWNER'S NAME <u>East Coast Homes</u>		For Insurance Company Use: Policy Number	
BUILDING STREET ADDRESS (Including Apt., Unit, Suite, and/or Bldg. No.) OR P.O. ROUTE AND BOX NO. <u>1328 Kyles Way</u>		Company NAIC Number	
CITY <u>Pooler</u>	STATE <u>GA</u>	ZIP CODE <u>31322</u>	
PROPERTY DESCRIPTION (Lot and Block Numbers, Tax Parcel Number, Legal Description, etc.) <u>lot 354 Phase 12 & 13 Garden Acres</u>			
BUILDING USE (e.g., Residential, Non-residential, Addition, Accessory, etc. Use Comments section if necessary.) <u>Residential</u>			
LATITUDE/LONGITUDE (OPTIONAL) (##° - ##' - ##.###" or ##.#####°)		HORIZONTAL DATUM: SOURCE: <input type="checkbox"/> GPS (Type): <input type="checkbox"/> USGS Quad Map <input type="checkbox"/> Other: _____	
		<input type="checkbox"/> NAD 1927 <input type="checkbox"/> NAD 1983	

SECTION B - FLOOD INSURANCE RATE MAP (FIRM) INFORMATION

B1. NFIP COMMUNITY NAME & COMMUNITY NUMBER <u>Pooler 130030</u>		B2. COUNTY NAME <u>Chatham</u>		B3. STATE <u>GA</u>	
B4. MAP AND PANEL NUMBER <u>130030-75</u>	B5. SUFFIX <u>C</u>	B6. FIRM INDEX DATE <u>9.20.98</u>	B7. FIRM PANEL EFFECTIVE/REVISED DATE <u>5.19.87</u>	B8. FLOOD ZONE(S) <u>AE</u>	B9. BASE FLOOD ELEVATION(S) (Zone AO, use depth of flooding) <u>14.0</u> <i>See Letter of map Revision Based on Fill</i>

B10. Indicate the source of the Base Flood Elevation (BFE) data or base flood depth entered in B9.
 FIS Profile FIRM Community Determined Other (Describe): _____

B11. Indicate the elevation datum used for the BFE in B9: NGVD 1929 NAVD 1988 Other (Describe): _____

B12. Is the building located in a Coastal Barrier Resources System (CBRS) area or Otherwise Protected Area (OPA)? Yes No
Designation Date: _____

SECTION C - BUILDING ELEVATION INFORMATION (SURVEY REQUIRED)

C1. Building elevations are based on: Construction Drawings* Building Under Construction* Finished Construction
*A new Elevation Certificate will be required when construction of the building is complete.

C2. Building Diagram Number 1 (Select the building diagram most similar to the building for which this certificate is being completed - see pages 6 and 7. If no diagram accurately represents the building, provide a sketch or photograph.)

C3. Elevations - Zones A1-A30, AE, AH, A (with BFE), VE, V1-V30, V (with BFE), AR, AR/A, AR/AE, AR/A1-A30, AR/AH, AR/AO
Complete Items C3a-i below according to the building diagram specified in Item C2. State the datum used. If the datum is different from the datum used for the BFE in Section B, convert the datum to that used for the BFE. Show field measurements and datum conversion calculation. Use the space provided or the Comments area of Section D or Section G, as appropriate, to document the datum conversion.

Datum NAVD/29 Conversion/Comments _____
Elevation reference mark used TRM Does the elevation reference mark used appear on the FIRM? Yes No

<input type="checkbox"/> a) Top of bottom floor (including basement or enclosure)	<u>15</u> . <u>91</u> ft.(m)
<input type="checkbox"/> b) Top of next higher floor	<u>N/A</u> . _____ ft.(m)
<input type="checkbox"/> c) Bottom of lowest horizontal structural member (V zones only)	<u>N/A</u> . _____ ft.(m)
<input type="checkbox"/> d) Attached garage (top of slab)	<u>13</u> . <u>62</u> ft.(m)
<input type="checkbox"/> e) Lowest elevation of machinery and/or equipment servicing the building	<u>15</u> . <u>21</u> ft.(m)
<input type="checkbox"/> f) Lowest adjacent grade (LAG)	<u>12</u> . <u>17</u> ft.(m)
<input type="checkbox"/> g) Highest adjacent grade (HAG)	<u>13</u> . <u>42</u> ft.(m)
<input type="checkbox"/> h) No. of permanent openings (flood vents) within 1 ft. above adjacent grade	<u>N/A</u>
<input type="checkbox"/> i) Total area of all permanent openings (flood vents) in C3h	<u>N/A</u> sq. in. (sq. cm)

License Number, Embossed Seal, Signature, and Date

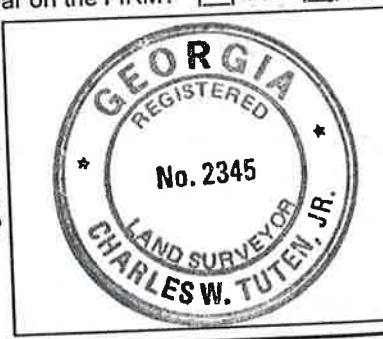

SECTION D - SURVEYOR, ENGINEER, OR ARCHITECT CERTIFICATION

This certification is to be signed and sealed by a land surveyor, engineer, or architect authorized by law to certify elevation information. I certify that the information in Sections A, B, and C on this certificate represents my best efforts to interpret the data available. I understand that any false statement may be punishable by fine or imprisonment under 18 U.S. Code, Section 1001.

CERTIFIER'S NAME <u>Charles W. Tutten, Jr.</u>		LICENSE NUMBER <u>GA PLS # 2345</u>	
TITLE <u>Land Surveyor</u>	COMPANY NAME <u>EMC Engineering Services, Inc.</u>		STATE <u>GA</u>
ADDRESS <u>23 E. Charleston St.</u>	CITY <u>Savannah</u>	STATE <u>GA</u>	ZIP CODE <u>31412</u>
SIGNATURE <u>Charles W. Tutten, Jr.</u>	DATE <u>8-24-00</u>	TELEPHONE <u>912-232-6533</u>	

IMPORTANT: In these spaces, copy the corresponding information from Section A.

BUILDING STREET ADDRESS (Including Apt., Unit, Suite, and/or Bldg. No.) OR P.O. ROUTE AND BOX NO.	For Insurance Company Use:
CITY	Policy Number
STATE	Company NAIC Number
ZIP CODE	

SECTION D - SURVEYOR, ENGINEER, OR ARCHITECT CERTIFICATION (CONTINUED)

Copy both sides of this Elevation Certificate for (1) community official, (2) insurance agent/company, and (3) building owner.

COMMENTS

260007 200 1000

10/17 2000 8000

190007

SECTION E - BUILDING ELEVATION INFORMATION (SURVEY NOT REQUIRED) FOR ZONE AO AND ZONE A (WITHOUT BFE)

For Zone AO and Zone A (without BFE), complete Items E1 through E4. If the Elevation Certificate is intended for use as supporting information for a LOMA or LOMR-F, Section C must be completed.

- E1. Building Diagram Number ____ (Select the building diagram most similar to the building for which this certificate is being completed - see pages 6 and 7. If no diagram accurately represents the building, provide a sketch or photograph.)
- E2. The top of the bottom floor (including basement or enclosure) of the building is ____ ft.(m) ____ in.(cm) ____ above or ____ below (check one) the highest adjacent grade.
- E3. For Building Diagrams 6-8 with openings (see page 7), the next higher floor or elevated floor (elevation b) of the building is ____ ft.(m) ____ in.(cm) above the highest adjacent grade.
- E4. For Zone AO only: If no flood depth number is available, is the top of the bottom floor elevated in accordance with the community's floodplain management ordinance? Yes No Unknown. The local official must certify this information in Section G.

SECTION F - PROPERTY OWNER (OR OWNER'S REPRESENTATIVE) CERTIFICATION

The property owner or owner's authorized representative who completes Sections A, B, and E for Zone A (without a FEMA-issued or community-issued BFE) or Zone AO must sign here.

PROPERTY OWNER'S OR OWNER'S AUTHORIZED REPRESENTATIVE'S NAME

ADDRESS

CITY STATE ZIP CODE

SIGNATURE DATE TELEPHONE

COMMENTS

SECTION G - COMMUNITY INFORMATION (OPTIONAL)

Check here if attachments

The local official who is authorized by law or ordinance to administer the community's floodplain management ordinance can complete Sections A, B, C (or E), and G of this Elevation Certificate. Complete the applicable item(s) and sign below.

- G1. The information in Section C was taken from other documentation that has been signed and embossed by a licensed surveyor, engineer, or architect who is authorized by state or local law to certify elevation information. (Indicate the source and date of the elevation data in the Comments area below.)
- G2. A community official completed Section E for a building located in Zone A (without a FEMA-issued or community-issued BFE) or Zone AO.
- G3. The following information (Items G4-G9) is provided for community floodplain management purposes.

G4. PERMIT NUMBER	G5. DATE PERMIT ISSUED	G6. DATE CERTIFICATE OF COMPLIANCE/OCCUPANCY ISSUED
-------------------	------------------------	---

- G7. This permit has been issued for: New Construction Substantial Improvement
- G8. Elevation of as-built lowest floor (including basement) of the building is: _____ ft.(m) Datum: _____
- G9. BFE or (in Zone AO) depth of flooding at the building site is: _____ ft.(m) Datum: _____

LOCAL OFFICIAL'S NAME

COMMUNITY NAME

SIGNATURE

COMMENTS

TITLE

TELEPHONE

DATE

Check here if attachments

FEDERAL EMERGENCY MANAGEMENT AGENCY
NATIONAL FLOOD INSURANCE PROGRAM

O.M.B. No. 3067-0077
Expires July 31, 2002

ELEVATION CERTIFICATE

Important: Read the instructions on pages 1 - 7.

SECTION A - PROPERTY OWNER INFORMATION

BUILDING OWNER'S NAME East Coast Homes			For Insurance Company Use: Policy Number		
BUILDING STREET ADDRESS (Including Apt., Unit, Suite, and/or Bldg. No.) OR P.O. ROUTE AND BOX NO. 1328 Ryan's Way			Company NAIC Number		
CITY Pooler	STATE GA	ZIP CODE 31322			
PROPERTY DESCRIPTION (Lot and Block Numbers, Tax Parcel Number, Legal Description, etc.) Lot 354, Garden Acres, Phase 12 & 13					
BUILDING USE (e.g., Residential, Non-residential, Addition, Accessory, etc. Use Comments section if necessary.) Residential					
LATITUDE/LONGITUDE (OPTIONAL) (##° - ##' - ##.###" or ##.#####°)		HORIZONTAL DATUM: <input type="checkbox"/> NAD 1927 <input type="checkbox"/> NAD 1983		SOURCE: <input type="checkbox"/> GPS (Type): _____ <input type="checkbox"/> USGS Quad Map <input type="checkbox"/> Other: _____	

SECTION B - FLOOD INSURANCE RATE MAP (FIRM) INFORMATION

B1. NFIP COMMUNITY NAME & COMMUNITY NUMBER Pooler		B2. COUNTY NAME Chatham		B3. STATE GA	
B4. MAP AND PANEL NUMBER 130030-75	B5. SUFFIX C	B6. FIRM INDEX DATE 9-20-95	B7. FIRM PANEL EFFECTIVE/REVISED DATE 5-19-87	B8. FLOOD ZONE(S) AE	B9. BASE FLOOD ELEVATION(S) (Zone AO, use depth of flooding) 14.0

- B10. Indicate the source of the Base Flood Elevation (BFE) data or base flood depth entered in B9.
 FIS Profile FIRM Community Determined Other (Describe): _____
- B11. Indicate the elevation datum used for the BFE in B9: NGVD 1929 NAVD 1988 Other (Describe): _____
- B12. Is the building located in a Coastal Barrier Resources System (CBRS) area or Otherwise Protected Area (OPA)? Yes No
Designation Date _____

SECTION C - BUILDING ELEVATION INFORMATION (SURVEY REQUIRED)

Building elevations are based on: Construction Drawings* Building Under Construction* Finished Construction
 *A new Elevation Certificate will be required when construction of the building is complete.

C2. Building Diagram Number 1 (Select the building diagram most similar to the building for which this certificate is being completed - see pages 6 and 7. If no diagram accurately represents the building, provide a sketch or photograph.)

C3. Elevations - Zones A1-A30, AE, AH, A (with BFE), VE, V1-V30, V (with BFE), AR, AR/A, AR/AE, AR/A1-A30, AR/AH, AR/AO
 Complete Items C3a-i below according to the building diagram specified in Item C2. State the datum used. If the datum is different from the datum used for the BFE in Section B, convert the datum to that used for the BFE. Show field measurements and datum conversion calculation. Use the space provided or the Comments area of Section D or Section G, as appropriate, to document the datum conversion.
 Datum NGVD/29 Conversion/Comments _____

Elevation reference mark used TBM Does the elevation reference mark used appear on the FIRM? Yes No

a) Top of bottom floor (including basement or enclosure) 15.91 ft.(m)

b) Top of next higher floor n/a . ____ft.(m)

c) Bottom of lowest horizontal structural member (V zones only) n/a . ____ft.(m)

d) Attached garage (top of slab) 15.62ft.(m)

e) Lowest elevation of machinery and/or equipment servicing the building n/a . ____ft.(m)

f) Lowest adjacent grade (LAG) 14.17ft.(m)

g) Highest adjacent grade (HAG) 15.42ft.(m)

h) No. of permanent openings (flood vents) within 1 ft. above adjacent grade n/a

i) Total area of all permanent openings (flood vents) in C3h n/a sq. in. (sq. cm)

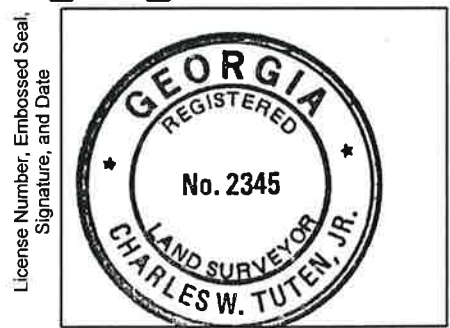

SECTION D - SURVEYOR, ENGINEER, OR ARCHITECT CERTIFICATION

This certification is to be signed and sealed by a land surveyor, engineer, or architect authorized by law to certify elevation information. I certify that the information in Sections A, B, and C on this certificate represents my best efforts to interpret the data available. I understand that any false statement may be punishable by fine or imprisonment under 18 U.S. Code, Section 1001.

CERTIFIER'S NAME Charles W. Tuten, Jr.		LICENSE NUMBER GA RLS 2345	
TITLE Land Surveyor		COMPANY NAME EMC Engineering Services, Inc.	
ADDRESS 23 East Chariton Street	CITY Savannah	STATE GA	ZIP CODE 31401
SIGNATURE <i>Charles W. Tuten, Jr.</i>		DATE 5-9-00	TELEPHONE 912-232-6533



Federal Emergency Management Agency

Washington, D.C. 20472

LETTER OF MAP REVISION BASED ON FILL DETERMINATION DOCUMENT (REMOVAL)

COMMUNITY AND MAP PANEL INFORMATION		LEGAL PROPERTY DESCRIPTION
COMMUNITY	TOWN OF POOLER, CHATHAM COUNTY, GEORGIA	Lot 343, Phase XII and Lots 354, 356, 372, 374, Phase XIII, Garden Acres Estates, as described and recorded on Plat Number 19-S-47, filed on December 7, 1999, by the Chatham County Register of Deeds
	COMMUNITY NO.: 130261	
AFFECTED MAP PANEL	NUMBER: 1300300075C	
	NAME: CHATHAM COUNTY, GEORGIA (UNINCORPORATED AREAS)	
	DATE: 5/19/87	
FLOODING SOURCE: HARDIN CANAL		APPROXIMATE LATITUDE & LONGITUDE OF PROPERTY: 32.104, -81.248 SOURCE OF LAT & LONG: MAPBLAST! DATUM: NAD83

DETERMINATION

LOT	BLOCK/ SECTION	SUBDIVISION	STREET	OUTCOME WHAT IS REMOVED FROM THE SFHA	FLOOD ZONE	1% ANNUAL CHANCE FLOOD ELEVATION (NGVD29)	LOWEST ADJACENT GRADE ELEVATION (NGVD29)	LOWEST FLOOR ELEVATION (NGVD29)	LOWEST LOT ELEVATION (NGVD29)
354	—	Garden Acres Estates	1328 Ryan's Way	Structure	X (shaded)	13.6 feet	14.2 feet	15.9 feet	13.2 feet

Special Flood Hazard Area (SFHA) - The SFHA is an area that would be inundated by the flood having a 1-percent chance of being equaled or exceeded in any given year (base flood).

ADDITIONAL CONSIDERATIONS (Please refer to the appropriate section on Attachment 1 for the additional considerations listed below.)

DETERMINATION TABLE (CONTINUED)
PORTIONS REMAIN IN THE SFHA
ANNEXATION

This document provides the Federal Emergency Management Agency's determination regarding a request for a Letter of Map Revision based on Fill for the property described above. Using the information submitted and the effective National Flood Insurance Program (NFIP) map, we have determined that the structure(s) on the property(ies) is/are not located in the SFHA, an area inundated by the flood having a 1-percent chance of being equaled or exceeded in any given year (base flood). This document revises the effective NFIP map to remove the subject property from the SFHA located on the effective NFIP map; therefore, the Federal mandatory flood insurance requirement does not apply. However, the lender has the option to continue the flood insurance requirement to protect its financial risk on the loan. A Preferred Risk Policy (PRP) is available for buildings located outside the SFHA. Information about the PRP and how one can apply is enclosed.

This determination is based on the flood data presently available. The enclosed documents provide additional information regarding this determination. If you have any questions about this document, please contact the FEMA Map Assistance Center toll free at (877) 336-2627 (877-FEMA MAP) or by letter addressed to the Federal Emergency Management Agency, P.O. Box 2210, Merrifield, VA 22116-2210.

Matthew B. Miller

Matthew B. Miller, P.E., Chief
Hazards Study Branch
Mitigation Directorate

Version 1.3.1

MX17300500336281LOMA36281SPF1

