

FEDERAL EMERGENCY MANAGEMENT AGENCY
NATIONAL FLOOD INSURANCE PROGRAM

O.M.B. No. 3067-0077
Expires July 31, 2002

ELEVATION CERTIFICATE

Important: Read the instructions on pages 1 - 7.

SECTION A - PROPERTY OWNER INFORMATION			For Insurance Company Use:
BUILDING OWNER'S NAME FRED WILLIAMS HOMEBUILDER, INC			Policy Number
BUILDING STREET ADDRESS (Including Apt., Unit, Suite, and/or Bldg. No.) OR P.O. ROUTE AND BOX NO. 149 BARRINGTON ROAD			Company NAIC Number
CITY POOLER	STATE GA	ZIP CODE 31322	
PROPERTY DESCRIPTION (Lot and Block Numbers, Tax Parcel Number, Legal Description, etc.) LOT 56 BARRINGTON ESTATES, PHASE 2			
BUILDING USE (e.g., Residential, Non-residential, Addition, Accessory, etc. Use Comments section if necessary.) Residential			
LATITUDE/LONGITUDE (OPTIONAL) (##-##-## or ##-###-##)	HORIZONTAL DATUM: <input type="checkbox"/> NAD 1927 <input type="checkbox"/> NAD 1983	SOURCE: <input type="checkbox"/> GPS (Type): _____ <input type="checkbox"/> USGS Quad Map <input type="checkbox"/> Other: _____	

SECTION B - FLOOD INSURANCE RATE MAP (FIRM) INFORMATION					
B1. NFIP COMMUNITY NAME & COMMUNITY NUMBER 130261 POOLER		B2. COUNTY NAME CHATHAM		B3. STATE GA	
B4. MAP AND PANEL NUMBER 130030-0075	B5. SUFFIX C	B6. FIRM INDEX DATE 9-20-95	B7. FIRM PANEL EFFECTIVE/REVISED DATE 5-19-87	B8. FLOOD ZONE(S) AE	B9. BASE FLOOD ELEVATION(S) (Zone AO, use depth of flooding) 13.0
B10. Indicate the source of the Base Flood Elevation (BFE) data or base flood depth entered in B9. <input type="checkbox"/> FIS Profile <input checked="" type="checkbox"/> FIRM <input type="checkbox"/> Community Determined <input type="checkbox"/> Other (Describe): _____					
B11. Indicate the elevation datum used for the BFE in B9: <input checked="" type="checkbox"/> NGVD 1929 <input type="checkbox"/> NAVD 1988 <input type="checkbox"/> Other (Describe): _____					
B12. Is the building located in a Coastal Barrier Resources System (CBRS) area or Otherwise Protected Area (OPA)? <input type="checkbox"/> Yes <input checked="" type="checkbox"/> No Designation Date _____					

SECTION C - BUILDING ELEVATION INFORMATION (SURVEY REQUIRED)

C1. Building elevations are based on: Construction Drawings* Building Under Construction* Finished Construction
*A new Elevation Certificate will be required when construction of the building is complete.

C2. Building Diagram Number 1 (Select the building diagram most similar to the building for which this certificate is being completed - see pages 6 and 7. If no diagram accurately represents the building, provide a sketch or photograph.)

C3. Elevations - Zones A1-A30, AE, AH, A (with BFE), VE, V1-V30, V (with BFE), AR, AR/A, AR/AE, AR/A1-A30, AR/AH, AR/AO
Complete Items C3a-i below according to the building diagram specified in Item C2. State the datum used. If the datum is different from the datum used for the BFE in Section B, convert the datum to that used for the BFE. Show field measurements and datum conversion calculation. Use the space provided or the Comments area of Section D or Section G, as appropriate, to document the datum conversion.
Datum _____ Conversion/Comments _____

Elevation reference mark used _____ Does the elevation reference mark used appear on the FIRM? Yes No

- o a) Top of bottom floor (including basement or enclosure) **14.4 ft(m)**
- o b) Top of next higher floor **N/A. ft(m)**
- o c) Bottom of lowest horizontal structural member (V zones only) **N/A. ft(m)**
- o d) Attached garage (top of slab) **14.0 ft(m)**
- o e) Lowest elevation of machinery and/or equipment servicing the building **13.0 ft(m)**
- o f) Lowest adjacent grade (LAG) **12.2 ft(m)**
- o g) Highest adjacent grade (HAG) **12.9 ft(m)**
- o h) No. of permanent openings (flood vents) within 1 ft. above adjacent grade **N**
- o i) Total area of all permanent openings (flood vents) in C3h **N/A** sq. in. (sq. cm)

License Number, Embossed Seal, Signature, and Date

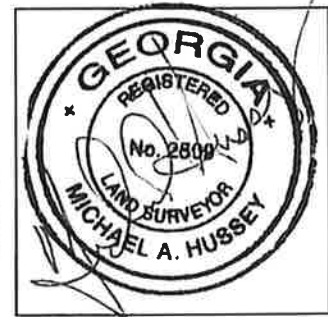

SECTION D - SURVEYOR, ENGINEER, OR ARCHITECT CERTIFICATION

This certification is to be signed and sealed by a land surveyor, engineer, or architect authorized by law to certify elevation information.
I certify that the information in Sections A, B, and C on this certificate represents my best efforts to interpret the data available.
I understand that any false statement may be punishable by fine or imprisonment under 18 U.S. Code, Section 1001.

CERTIFIER'S NAME **Michael A. Hussey** LICENSE NUMBER **2509**

TITLE Land Surveyor	COMPANY NAME		
ADDRESS 129 Junco Way	CITY Savannah	STATE GA	ZIP CODE 31419
SIGNATURE <i>Michael A. Hussey</i>	DATE 02/15/05	TELEPHONE 912-925-3866	

IMPORTANT: In these spaces, copy the corresponding information from Section A.			For Insurance Company Use:
BUILDING STREET ADDRESS (Including Apt., Unit, Suite, and/or Bldg. No.) OR P.O. ROUTE AND BOX NO. 149 BARRINGTON ROAD			Policy Number
CITY POOLER	STATE GA	ZIP CODE 31322	Company NAIC Number

SECTION D - SURVEYOR, ENGINEER, OR ARCHITECT CERTIFICATION (CONTINUED)

Copy both sides of this Elevation Certificate for (1) community official, (2) insurance agent/company, and (3) building owner.

COMMENTS
N/A

Check here if attachments

SECTION E - BUILDING ELEVATION INFORMATION (SURVEY NOT REQUIRED) FOR ZONE AO AND ZONE A (WITHOUT BFE)

For Zone AO and Zone A (without BFE), complete Items E1 through E4. If the Elevation Certificate is intended for use as supporting information for a LOMA or LOMR-F, Section C must be completed.

- E1. Building Diagram Number __ (Select the building diagram most similar to the building for which this certificate is being completed - see pages 6 and 7. If no diagram accurately represents the building, provide a sketch or photograph.)
- E2. The top of the bottom floor (including basement or enclosure) of the building is __ ft.(m) __ in.(cm) above or below (check one) the highest adjacent grade.
- E3. For Building Diagrams 6-8 with openings (see page 7), the next higher floor or elevated floor (elevation b) of the building is __ ft.(m) __ in.(cm) above the highest adjacent grade.
- E4. For Zone AO only: If no flood depth number is available, is the top of the bottom floor elevated in accordance with the community's floodplain management ordinance?
 Yes No Unknown. The local official must certify this information in Section G.

SECTION F - PROPERTY OWNER (OR OWNER'S REPRESENTATIVE) CERTIFICATION

The property owner or owner's authorized representative who completes Sections A, B, and E for Zone A (without a FEMA-issued or community-issued BFE) or Zone AO must sign here.

PROPERTY OWNER'S OR OWNER'S AUTHORIZED REPRESENTATIVE'S NAME			
ADDRESS	CITY	STATE	ZIP CODE
SIGNATURE	DATE	TELEPHONE	
COMMENTS			

Check here if attachments

SECTION G - COMMUNITY INFORMATION (OPTIONAL)

The local official who is authorized by law or ordinance to administer the community's floodplain management ordinance can complete Sections A, B, C (or E), and G of this Elevation Certificate. Complete the applicable item(s) and sign below.

- G1. The information in Section C was taken from other documentation that has been signed and embossed by a licensed surveyor, engineer, or architect who is authorized by state or local law to certify elevation information. (Indicate the source and date of the elevation data in the Comments area below.)
- G2. A community official completed Section E for a building located in Zone A (without a FEMA-issued or community-issued BFE) or Zone AO.
- G3. The following information (Items G4-G9) is provided for community floodplain management purposes.

G4. PERMIT NUMBER	G5. DATE PERMIT ISSUED	G6. DATE CERTIFICATE OF COMPLIANCE/OCCUPANCY ISSUED
-------------------	------------------------	---

G7. This permit has been issued for: New Construction Substantial Improvement

G8. Elevation of as-built lowest floor (including basement) of the building is:

_____. ft.(m) Datum: _____

G9. BFE or (in Zone AO) depth of flooding at the building site is:

_____. ft.(m) Datum: _____

LOCAL OFFICIAL'S NAME	TITLE
COMMUNITY NAME	TELEPHONE
SIGNATURE	DATE
COMMENTS	

Check here if attachments